

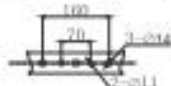

LTG15-60

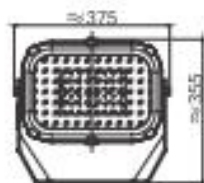

LTG15-100

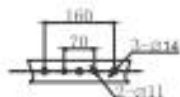
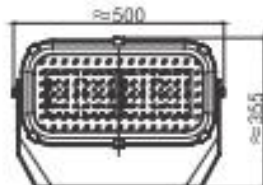

► **适用范围：**

该灯具适用于港口及各类船舶露天甲板、货仓等大面积照射使用。

► **产品特性：**

1. 灯壳采用优质不锈钢材模压成型。
2. 采用高光效的 LED 光源，具有超高亮度，耐热性能好，光衰小，品质性能稳定等特点。
3. 独特的鳍片式散热体设计，有效将热量传导扩散，散热效率高，从而降低灯体内的温度，保证了光源和电源的寿命。
4. 采用特殊的表面处理工艺，外观美观新颖，安装简单，拆卸方便，适用范围广。
5. 电缆外径 $\Phi 9 \sim \Phi 12\text{mm}$ 。

► **采用标准：**

1. 符合国际 IEC60598-1-2014, IEC60598-2-5: 1998 标准
2. 符合《钢质海船入级规范》。

► **The scope of application:**

This light can be used in large places of all kinds of ships, ports, open deck of marine ship and cargo warehouse for illumination.

► **Products feature:**

1. The shell of light adopt good quality stainless steel material by compression molding.
2. Adopt high photosynthetic efficiency of LED light source, with high brightness and good heat resistant performance, light failure is small; stable quality performance etc.
3. Unique design of the fin type radiator body, with effectively conduct heat diffusion, high cooling efficiency, thereby reducing the lamp body temperature, ensure the service life of the light source and power supply.
4. The surface of light adopts special treatment technology, beautiful and novel appearance, simple installation, convenient dis-assembly, wide application scope.
5. Cable outside diameter: $\Phi 9 \sim \Phi 12\text{mm}$

► **Adopt standard:**

1. Conform to international standard of IEC60598-1-2014, IEC60598-2-5: 1998
2. Conform to GRADE ENTRY NORMS FOR STEEL SHIPS.

型号 Type	LTG15-60	LTG15-100
电压 / 频率 Voltage/frequency	100 - 240V/AC 50/60Hz	
LED 功率 Power (W)	60W	100W
光通量 (Lm) Luminous flux	550lm	900lm
相关色温 (K) Color Temperature	5000 - 6500K	
显色指数 Color Rendering Index	75	
光源使用寿命 Working Life-span (hrs)	> 50000h	
重量 (Kg) Weight	6.8KG	9.5KG
防护等级 Protection class	IP67	